

## 7.1.2

### **Geo-tagged photographs/videos of the facilities**

## 7.1.2.: Geo-tagged photographs/videos of the facilities

### INDEX

Sr. No	Contents	Page Number	
<b>7.1.2.1</b>	<b>ALTERNATE SOURCES OF ENERGY AND ENERGY CONSERVATION MEASURES</b>		
1.	Solar Energy Plant	4-8	<a href="#">View Document</a>
2.	Wheeling to Grid	9-10	<a href="#">View Document</a>
3.	Sensor-based energy conservation	11-12	<a href="#">View Document</a>
4.	Use of LED bulbs/Power Efficient Equipments	12	<a href="#">View Document</a>
5.	Biogas Plant	14	<a href="#">View Document</a>
6.	Well Ventilated Classroom and Laboratories	15	<a href="#">View Document</a>
7.	Smart Energy Meter Installation	16	<a href="#">View Document</a>
8.	Energy Conservation Measures (Sign Boards)	17	<a href="#">View Document</a>
<b>7.1.2.2</b>	<b>MANAGEMENT OF THE VARIOUS TYPES OF DEGRADABLE AND NON-DEGRADABLE WASTE</b>	18-28	<a href="#">View Document</a>
1	Solid Waste Management - M/s D. M. Services, Pune ( <b>Recycle</b> )	20-21	<a href="#">View Document</a>
2.	Wet Waste Management ( <b>Rot</b> ) – Bio-decompost Pits	22-23	<a href="#">View Document</a>
3.	ERP System - Akron Systems( <b>Reduce</b> )	24	<a href="#">View Document</a>
4.	Hazardous chemicals Management	25-26	<a href="#">View Document</a>
5.	Material Safety Data Sheets	27	<a href="#">View Document</a>
6.	Awareness Boards ( <b>Refuse</b> )	28	<a href="#">View Document</a>
<b>7.1.2.3</b>	<b>WATER CONSERVATION</b>	29-43	
1.	Rain Water Harvesting System	29	<a href="#">View Document</a>
2.	Pits for Rain Water Discharge	30	<a href="#">View Document</a>
3.	Borewell Recharge	31	<a href="#">View Document</a>
4.	Sprinklers for lawn area to save water wastage	32	<a href="#">View Document</a>
5.	Drip irrigation technique for lawn area	33-34	<a href="#">View Document</a>

6.	Maintenance of Water Bodies and Distribution System in the Campus	35	<a href="#">View Document</a>
7.	Awareness for Water Conservation (Sign Boards)	38	<a href="#">View Document</a>
<b>7.1.2.4</b>	<b>Green campus initiatives</b>	37-43	
1.	Green & Clean Campus	37-38	<a href="#">View Document</a>
2.	Wet Waste Decompost Plant in Medicinal Garden	39	<a href="#">View Document</a>
3.	Metro Station near Campus	40-41	<a href="#">View Document</a>
4.	Promoting Use of Electric Vehicles	42	<a href="#">View Document</a>
5.	Promoting Use of Bicycles (Bicycle Stand)	43	<a href="#">View Document</a>
<b>7.1.2.5</b>	<b>DIYANGJAN-FRIENDLY, BARRIER FREE ENVIRONMENT</b>	44-58	
1.	<b>Built in environment with ramps/lifts for easy access to classrooms</b>		
	A. Physical facilities (Spacious Corridors for easy movement and access to classrooms and laboratories)	44	<a href="#">View Document</a>
	B. Provision for lift (Easy movement and access to classrooms and laboratories)	45-46	<a href="#">View Document</a>
	C. Ramp / Rails (To Parking Area as well as Upstairs – Easy movement and access to classrooms and laboratories)	47-48	<a href="#">View Document</a>
2.	<b>Diyangjan accessible washrooms</b>	49	<a href="#">View Document</a>
3.	<b>Signage including tactile path, lights, display boards and signposts</b>	50-52	<a href="#">View Document</a>
4.	<b>A) Assistive Technology and facilities for persons with disabilities (Diyangjan) accessible website, screen-reading software, mechanized equipment</b>	53-54	<a href="#">View Document</a>
	<b>B) Software</b>	55	<a href="#">View Document</a>
5.	<b>Provision for enquiry and information: Human assistance, reader, scribe, soft copies of reading material, screen reading - Scribes/Extra Time for examination (As per Savitribai Phule Pune University Rules)</b>	56-58	<a href="#">View Document</a>



# AISSMS

## COLLEGE OF PHARMACY

IMPARTING EXCELLENCE IN EDUCATION & RESEARCH



Approved by AICTE & PCI New Delhi, Recognized by the Government of Maharashtra,  
2F,12B recognition by UGC, Affiliated to Savitribai Phule Pune University  
Accredited by NAAC with A Grade

### 7.1.2.1: INSTITUTION HAS FACILITIES FOR ALTERNATE SOURCES OF ENERGY AND ENERGY CONSERVATION MEASURES

#### 1. Solar Energy Plant

As part of energy conservation and use of renewable energy solar panel installation on terrace of the institutions in the campus has been executed and it is connected to MSEB grid. The solar system is installed by Bosch Inc.

**Project Details: 300 kWp Grid Connected Rooftop Solar PV Plant**

**Locations:**

1. AISSMS College of Pharmacy – 50 KW
2. AISSMS College of Engineering and Polytechnic - – 150 KW
3. AISSMS Institute of Information Technology - – 100 KW

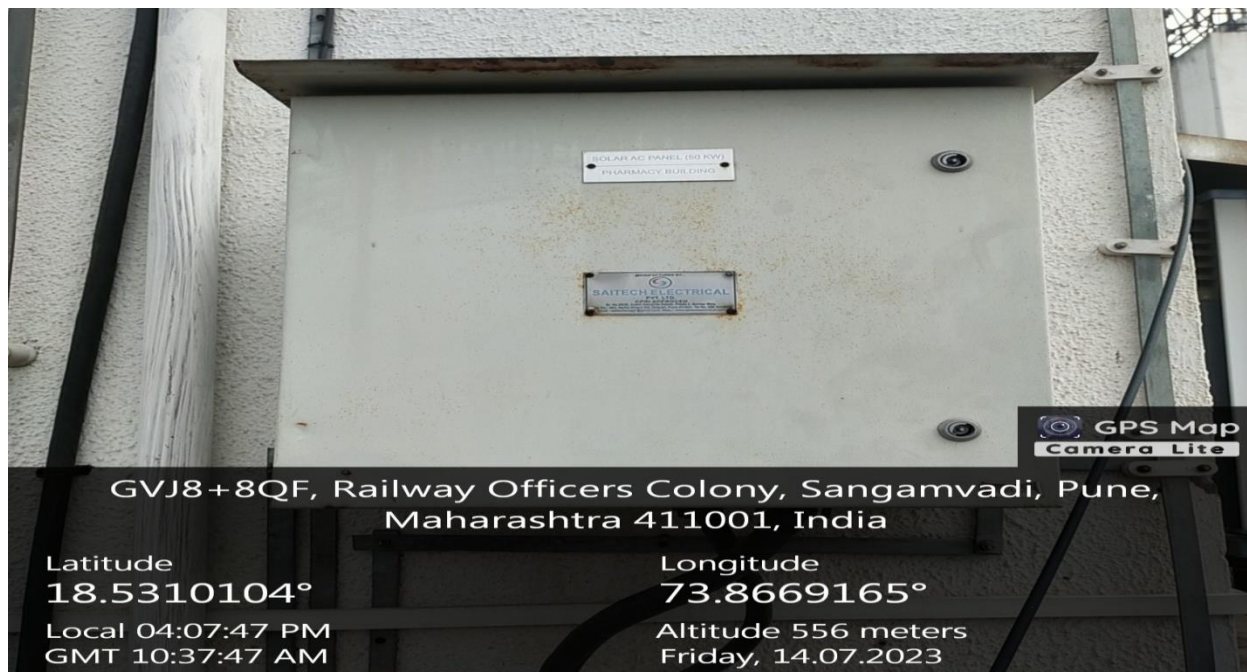

[BACK TO INDEX](#)



**GVJ8+8QF, Railway Officers Colony, Sangamvadi, Pune, Maharashtra 411001, India**

Latitude  
**18.5310104°**  
Local 04:07:29 PM  
GMT 10:37:29 AM

Longitude  
**73.8669165°**  
Altitude 556 meters  
Friday, 14.07.2023

GPS Map  
Camera Lite



**GVJ8+8QF, Railway Officers Colony, Sangamvadi, Pune, Maharashtra 411001, India**

Latitude  
**18.5310104°**  
Local 04:06:14 PM  
GMT 10:36:14 AM

Longitude  
**73.8669165°**  
Altitude 556 meters  
Friday, 14.07.2023

GPS Map  
Camera Lite



**GVJ8+8QF, Railway Officers Colony, Sangamvadi, Pune, Maharashtra 411001, India**

Latitude  
**18.5310104°**  
Local 04:06:02 PM  
GMT 10:36:02 AM

Longitude  
**73.8669165°**  
Altitude 556 meters  
Friday, 14.07.2023

GPS Map  
Camera Lite

[BACK TO INDEX](#)

**A. Solar Energy Plant at AISSMS Campus (Installation and Distribution Structure)**

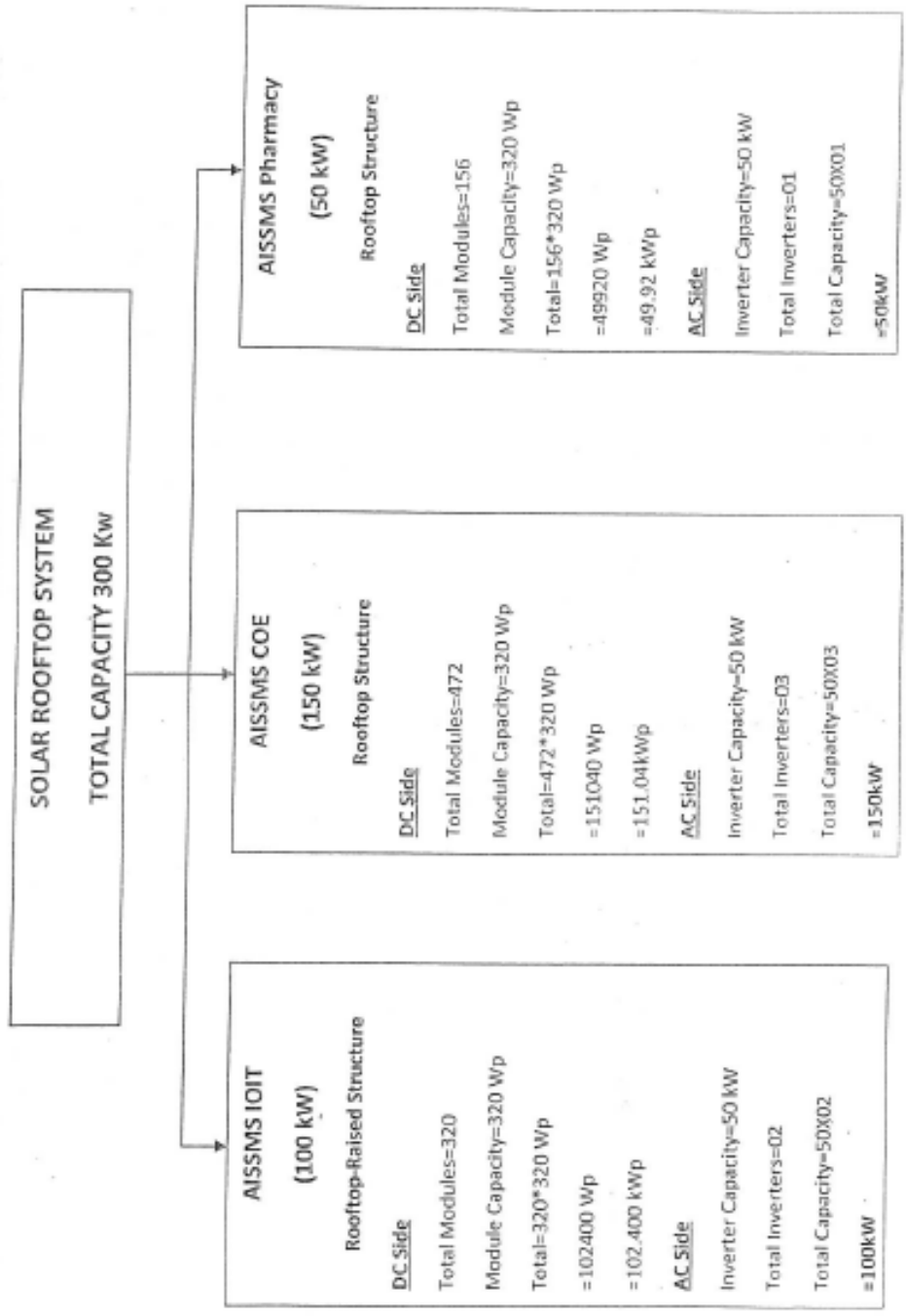

[BACK TO INDEX](#)

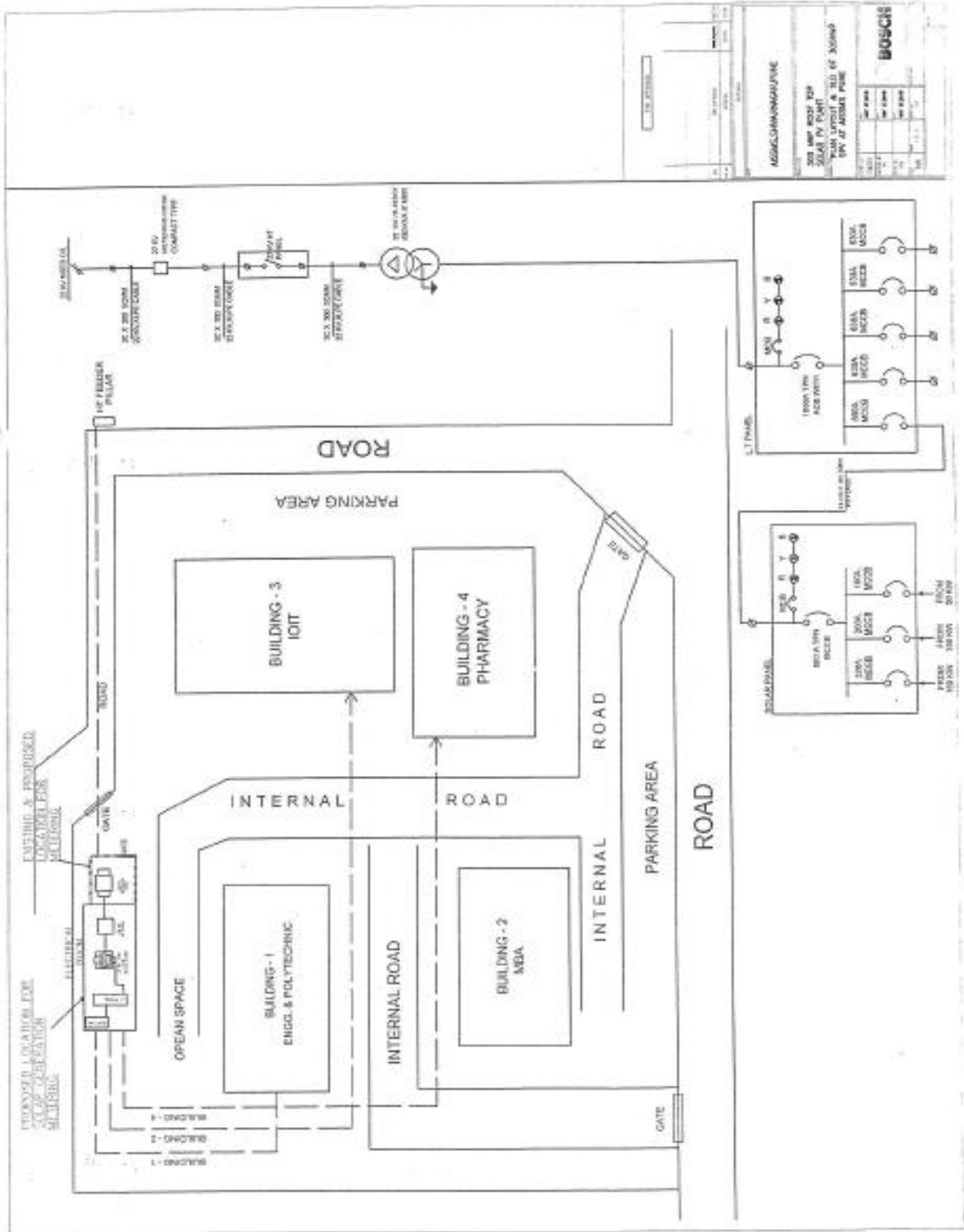

[BACK TO INDEX](#)

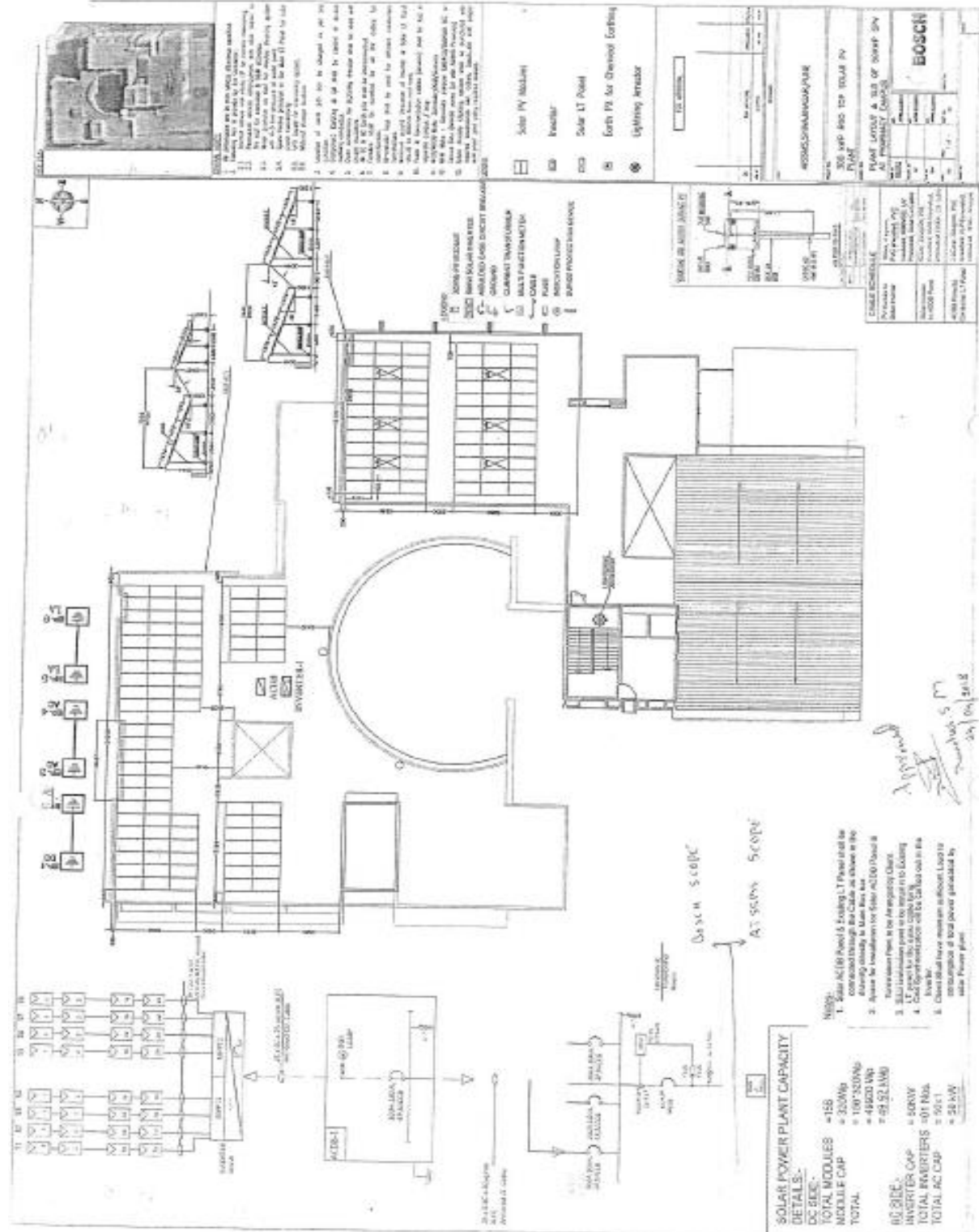

[BACK TO INDEX](#)



## 2. Wheeling to Grid

THE ENERGY GENERATED BY SOLAR PANEL IS CONNECTED TO MSEB GRID.

Project Details: 300 kWp Grid Connected Rooftop Solar PV Plant

Ver 1.24.03

Page 1



**Maharashtra State Electricity Distribution Co. Ltd.**

**BILL OF SUPPLY FOR THE MONTH OF JAN-2023** 202301351905080  
 GSTIN: 27AAEC12933K1ZB Website: www.mahadiscom.in HSN CODE: 27180000  
 RASTAPETH CIRCLE - 519 B'GARDEN DIVN. - 303 WADIA CC SUB-DIVN. - 601 1

Consumer No. : 170019009397	BILL DATE : 04/02/2023	7,01,200.00
Consumer Name : M/S S.S.P.M.S.ENGINEERING COLLEGE	DUE DATE : 20/02/2023	
Address : S.NO.438 F.P.NO.94A SANGAMWADI R.B.MILL ROAD	IF PAID UPTO : 10/02/2023	6,95,480.00
Village : PUNE411001 Pin Code : 411001	IF PAID AFTER : 20/02/2023	7,09,970.00
Email : ***smscofinance@gmail.com	Last Receipt No./Date : 0000015336 / 10-01-2023	
Mobile No. : 95*****96 Meter No. : 055-XE418599 Seasonal : Load Shed Ind : INDUST	Last Month Payment : 8,01,820.00	
Sanctioned Load (KW): 300 Connected Load (KW) : 300.00 Urban/Rural : Urban Express Feeder : No	Scale / Sector : Small Scale /	
Contract Demand (KVA) : 500.00 65% of Con. Demand (KVA) : 325.00 Feeder Voltage (KV) : 11 LIS Indicator :		
Tariff : 146 HT-VIII B old trf HT-VIII B		

Date of Connection : 14/01/1999	Category : PUBL. SERVICES OTH	GSTIN :
Supply at : HT	Elec. Duty : 06 PART B	PAN : AAAAA4699N
Prev. Highest (Mth) : OCT	Prev. Highest Bill Demand (KVA) : 311	
S.D. Held Rs. : 10,43,100.00	Addl. S.D. Demanded Rs. : 0.00	MIDC Zone: OTHER
Bank Guarantee Rs. : 0	S.D. Arrears Rs. : 0.00	

BILLING HISTORY			
Bill Month	Units	Bill Demand(KVA)	Bill Amount
DEC-22	46,224	325	8,08,416
NOV-22	50,719	325	8,70,458
OCT-22	40,675	325	7,28,250
SEP-22	55,301	325	9,36,651
AUG-22	47,184	325	8,21,296
JUL-22	53,767	325	9,14,292
JUN-22	49,728	325	8,58,191
MAY-22	61,151	325	9,02,507
APR-22	57,918	325	8,63,372
MAR-22	63,463	300	9,30,806
FEB-22	44,289	300	6,82,893
JAN-22	49,328	300	7,44,038

**CUSTOMER CARE Toll Free No.**  
 1912, 1800-233-3435, 1800-212-3435

IGRC: Office of the Superintending Engineer, MSEDCCL Rastapeth Urban Circle, Administrative Building,, Phone - 020-26062385

In case of non-redressal of grievance here, consumer may make his representation to below forum

CGRF: 825, Administrative Building, 2nd Floor, Kasba Peth, Pune 411011., Phone - 020-24570620

For making Energy Bill payment through RTGS/NEFT mode, use following details

- Beneficiary Name: MSEDCCL
- Beneficiary Account Number: MSEDH01170019008387
- IFSC Code: SBIN0008996 (fifth, sixth and seventh character is zero)
- Name of Bank: SBI Bank
- Name of Branch: IFB, BKC Branch-MSEDCCL

Disclaimer: Please use above bank details only for payment against consumer number mentioned in beneficiary account number.



- Tariff Revised w.e.f. 01.04.2022. Tariff Order is available at Mahavitaran Portal.
- Physical Bills are not served. You can view and pay bill online at portal <https://wsc.mahadiscom.in/wsc/wsc>
- Consumer can pay bill through portal using various online modes.
- As per Income Tax provision vide section 288 8T each receipt of Rs. 2.00 lakhs and above will not be accepted by MSEDCCL against any type of payment.
- As per MERC order dt. 24/02/2021, monthly energy bill payment in each is limited Rs.6000/- w.e.f. 01/11/2021.
- As per GoM Notification dtd. 14.08.2020, rate of Electricity Duty for Parl-F Industrial is revised from 8.3% to 7.6% from billing month Aug-20
- Activity: EDUCATIONAL INSTITUTIONS SCHOOLS AND COLLEGES OTHER THAN THE STATE OR CENTRAL GOVERNMENT OR LOCAL SELF GOV.BODIES

[BACK TO INDEX](#)

CURRENT CONSUMPTION DETAILS						
Reading Date	KWH	KVAH	RKVAH (LAG)	RKVAH (LEAD)	KW (MD)	KVA (MD)
Current 31/01/2023	207432.500		22810.500	5318.000	31.280	31.480
Previous 31/12/2022	198898.000		22249.000	4865.000		
Difference	8534.500		561.500	453.000		
Multiplying Factor	5.000		5.000	5.000	5.000	5.000
Consumption	42672.500		2807.500	2265.000	156.400	157.400
L.T. Metering	0.000		0.000	0.000	0.000	0.000
Adjustment <sup>Solar</sup>	-4371.000		0.000	0.000	0.000	0.000
Assessed Consumption	0.000		0.000	0.000	0.000	0.000
Total Consumption	38302.000	38572.000	2808.000	2265.000	156.000	157.000

BILLING DETAILS				Amount in Rs.		
Billed Demand (KVA)	325	@ Rs.	454.00	Demand Charges	1,47,550.00	
Assessed P.F.		Avg. P.F.	0.993	Wheeling Charge @ 0.55 Rs/U	21,214.60	
Billed P.F.	0.993	L.F.	12	Energy Charges	3,45,605.12	
Consumption Type	Units	Rate	Charges Rs.	TOD Tariff EC	- 9,055.00	
Industrial	38,572	8.96	3,45,605.12	FAC @ 175.00 Ps/U	67,501.00	
Residential	0	5.70	0.00	Electricity Duty	1,20,291.30	
Commercial	0	10.95	0.00	Bulk Consumption Rebate	0.00	
E.D. on (Rs.)	Rate %	Amount Rs.		Tax on Sale @ 19.04 Ps/U	7,292.70	
0.00	0.00	0.00		Incremental Consumption Rebate	0.00	
0.00	16.00	0.00		Charges For Excess Demand	0.00	
5,72,815.72	21.00	1,20,291.30		Tax Collection at Source	807.55	
TOD Zone	Rate	Units	Demand	Charges Rs.	Debit Bill Adjustment	0.00
00:00 Hrs-06:00 Hrs & 22:00 Hrs-24:00 Hrs	-1.50	14,738	92.00	-22107.00		
06:00Hrs-09:00Hrs & 12:00Hrs-18:00Hrs	0.00	11,268	157.00	0.00		
09:00 Hrs-12:00 Hrs	0.80	2,565	155.00	2052.00		
18:00 Hrs-22:00 Hrs	1.10	10,000	110.00	11000.00		
Amount In Words	SEVEN LAKH ONE THOUSAND TWO HUNDRED ONLY					
				<b>TOTAL CURRENT BILL</b>	<b>7,01,207.27</b>	
				Current Interest 01/02/2023	0.00	
				Principal Arrears	- 3.41	
				Interest Arrears	0.00	
				<b>Total Bill Amount (Rounded) Rs.</b>	<b>7,01,200.00</b>	
				Delay Payment Charges Rs.	8,765.09	
				Amount Payable After 20/02/2023	<b>7,09,970</b>	
				(Amount Rounded to Nearest Rs. 10/-)		

Total Solar Generation Units : 31102; Rooftop Solar Units Export : 4370, Import : 42673, Adjusted : 4371, Bank : 0; Rooftop Solar (Net Metering) Capacity : 300 KW; Rooftop Solar installation Month : Apr-19;  
\*\*\*\* PROMPT DISCOUNT Rs. 5728 IF PAID ON OR BEFORE 10-FEB-23

Export / Generation Meter Readings						
Meter Type	Current Reading		MF	Consumption Adjustment	SLOTWISE UNITS	
	Previous Reading	Difference			Slot 1	Slot 3
Meter Serial Number				Total Consumption	Slot 2	Slot 4
<b>TOD EXPORT METER</b>	31/01/23	31388.50	5.00	4370.00		
555-XE418599	31/12/22	30514.50		0.00	0.00	1473.00
		874.00		4370	2898.00	0.00
<b>TOD SOLAR GENERATION METER</b>	31/01/23	16113.37	80.00	31102.00		
055-XE491871	31/12/22	15724.59		0.00	0.00	11004.00
		388.78		31102	20075.00	23.00

[BACK TO INDEX](#)

### 3. Sensor-based energy conservation

Sensor Based Lights for energy conservation are installed at Toilets and Common Passages





[BACK TO INDEX](#)

#### 4. Use of LED bulbs/power efficient equipment

As per policy of infrastructure committee, the old burnt-out tubes are timely replaced with LED tube lights for energy conservation. All Sophisticated Equipments in Laboratories are tested and installed as per Installation Qualification Guidelines

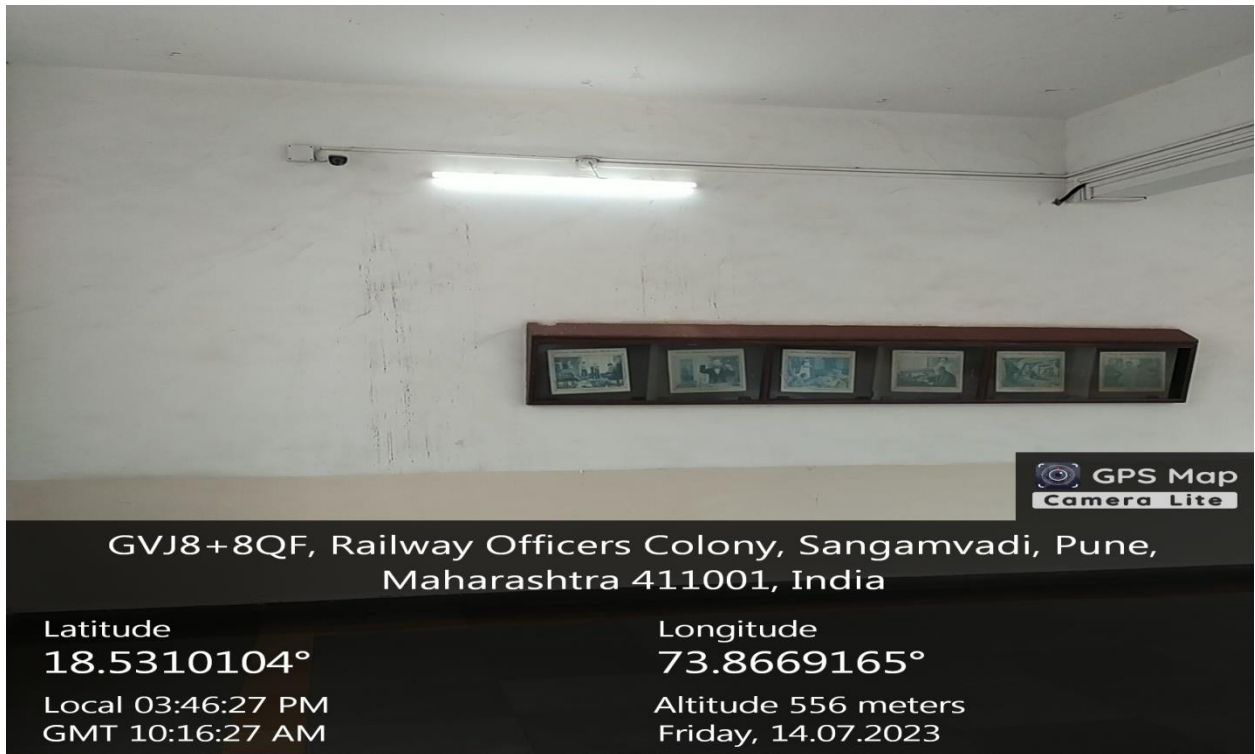

[BACK TO INDEX](#)

## 5. Biogas Plant



[BACK TO INDEX](#)

## 6. Classrooms and Laboratories are designed to natural light and ventilation



[BACK TO INDEX](#)

## 7. Smart Energy Meter Installation



[BACK TO INDEX](#)



## 8. Energy Conservation Measures (Sign Boards)



[BACK TO INDEX](#)

## 7.1.2.2: MANAGEMENT OF THE VARIOUS TYPES OF DEGRADABLE AND NON-DEGRADABLE WASTE



The college has efficient system for waste management. The building premises are cleaned everyday and the work has been outsourced to M/s D. M. Services. The cleaners collect the solid waste in appropriate containers and these wastes are handed over to Pune Municipal Corporation for disposal. **Reduce and reuse** policy is used to minimize waste generation. Wet waste (Dry and Wet Leaves, Food) is collected and decomposed using wet waste decomposing unit which is being used as fertilizer for medicinal plant garden (**Rot**). As well as empty glass bottle scarp handed over to New Neeta Chemicals, Pune (**Recycle**).

The extent of liquid chemical waste generated is negligible which is diluted with water and flushed through drainage system.

The college has collaboration with Pasco Environmental Solutions Pvt. Ltd., Pune for collection and disposal of dead and sacrificed animal waste.

E-waste management: Monitors and CPUs are **repaired and reused** in most of the cases. Non-repairable Computers, Monitors, OHP, LCD projectors, peripherals and UPS batteries are collected and handed over for proper **recycle of spare parts/disposal** to M/s Sakshi Enterprises who is approved scrap dealer.

Waste generated from microbiology laboratories is autoclaved and then disposed off.

Hazardous chemicals required for laboratory usage are stored isolated as per norms and handled carefully under the supervision of staff in fume hoods. The Sign boards are displayed as well as Material Safety Data Sheets are provided in laboratories in case of any immediate corrective actions required.

College has displayed Awareness Boards as well as conducts awareness programs to minimize waste generation (**Refuse**)

The college does not deal with radioactive substances.

## 1. Solid Waste Management - M/S D. M. Services, Pune

Collection and Segregation of Dry and Wet Waste



[BACK TO INDEX](#)

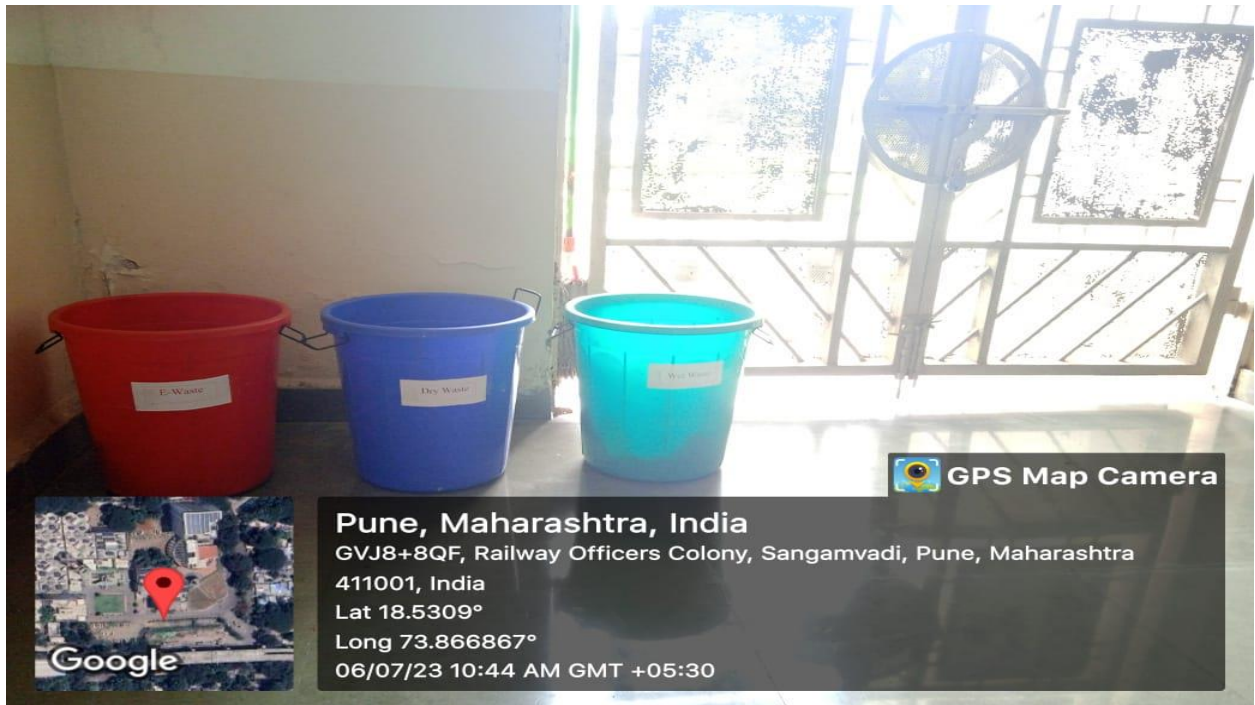

[BACK TO INDEX](#)

## 2. Bio-Decomposting (Wet Waste Management)



[BACK TO INDEX](#)



[BACK TO INDEX](#)

### 3. ERP Software Usage - Reduce Extent of Paper Work

The screenshot shows the 'DOCUMENT TYPE LIST' page in the WEBDESK LMS. The page features a sidebar with navigation options, a header with the college name 'AISSMS, College of Pharmacy, Pune' and the user profile 'Dr. SANTOSH VILASCHAND GANDHI', and a main content area with a table of document types.

ACTION	Sr. No.	DOCUMENT TYPE
	1	PDF
	2	VIDEO
	3	WORD FILE
	4	PPT
	5	EXCEL

The screenshot shows the 'TEACHER PLAN' page in the WEBDESK LMS. The page features a sidebar with navigation options, a header with the college name 'AISSMS, College of Pharmacy, Pune' and the user profile 'Dr. SANTOSH VILASCHAND GANDHI', and a main content area with a table of teaching plans.

Action	PROGRAM NAME	PROGRAM YEAR	SEMESTER	DIVISION	COURSE
	Master of Pharmacy in Pharmacology	FY	SEMESTER 1	A	Modern Pharmaceutical Analytical Techniques
	Master of Pharmacy in Pharmaceutical Quality Assurance	FY	SEMESTER 1	A	Modern Pharmaceutical Analytical Techniques
	Master of Pharmacy in Pharmaceutical Chemistry	FY	SEMESTER 1	A	Modern Pharmaceutical Analytical Techniques
	Master of Pharmacy in Pharmaceutics	FY	SEMESTER 1	A	Modern Pharmaceutical Analytical Techniques
	Bachelor of Pharmacy	FINAL YEAR	SEMESTER 7	A	Instrumental Methods of Analysis
	Bachelor of Pharmacy	FINAL YEAR	SEMESTER 7	B	Instrumental Methods of Analysis

[BACK TO INDEX](#)



**4. Hazardous chemicals required for laboratory usage are stored isolated as per norms and handled carefully under the supervision of staff in fume hoods.**



[BACK TO INDEX](#)



[BACK TO INDEX](#)

5. Material Safety Data Sheets are provided in laboratories in case of any immediate corrective actions required.

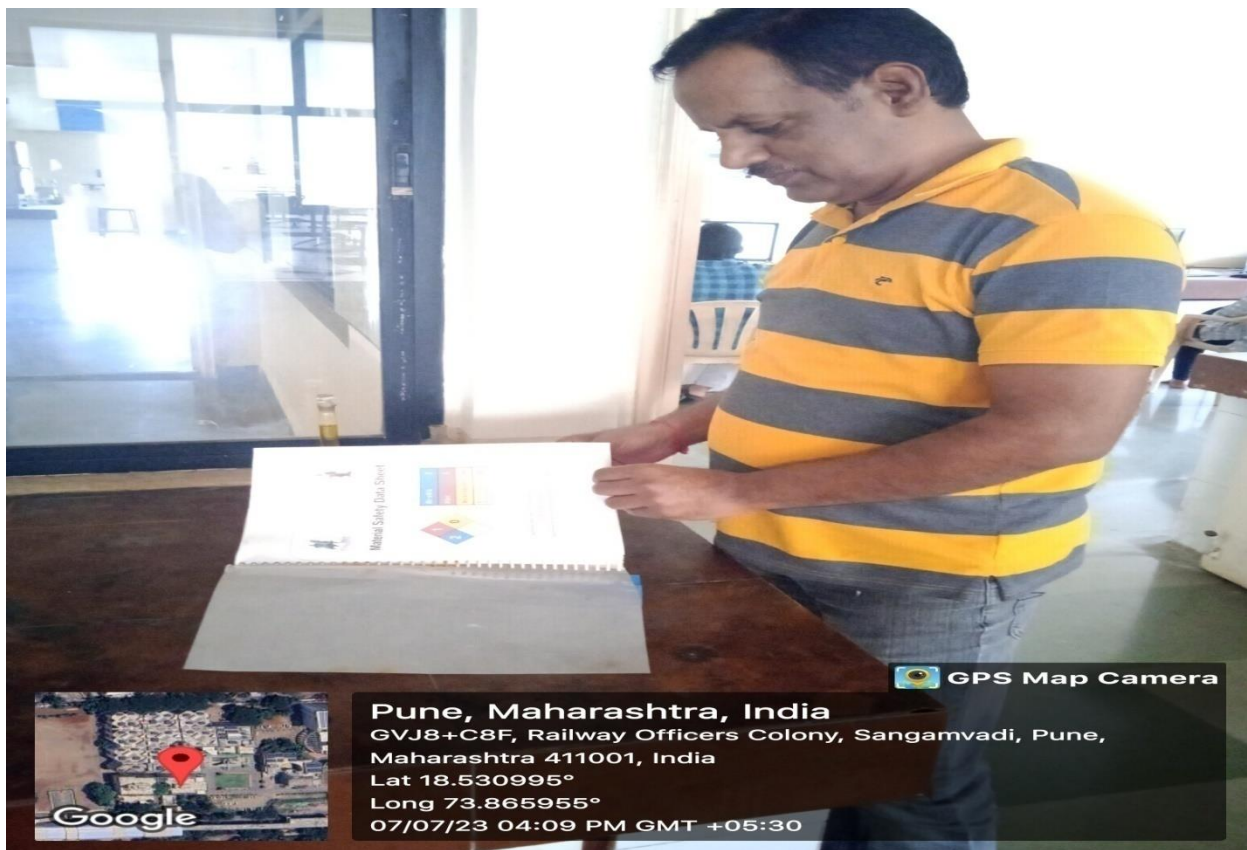
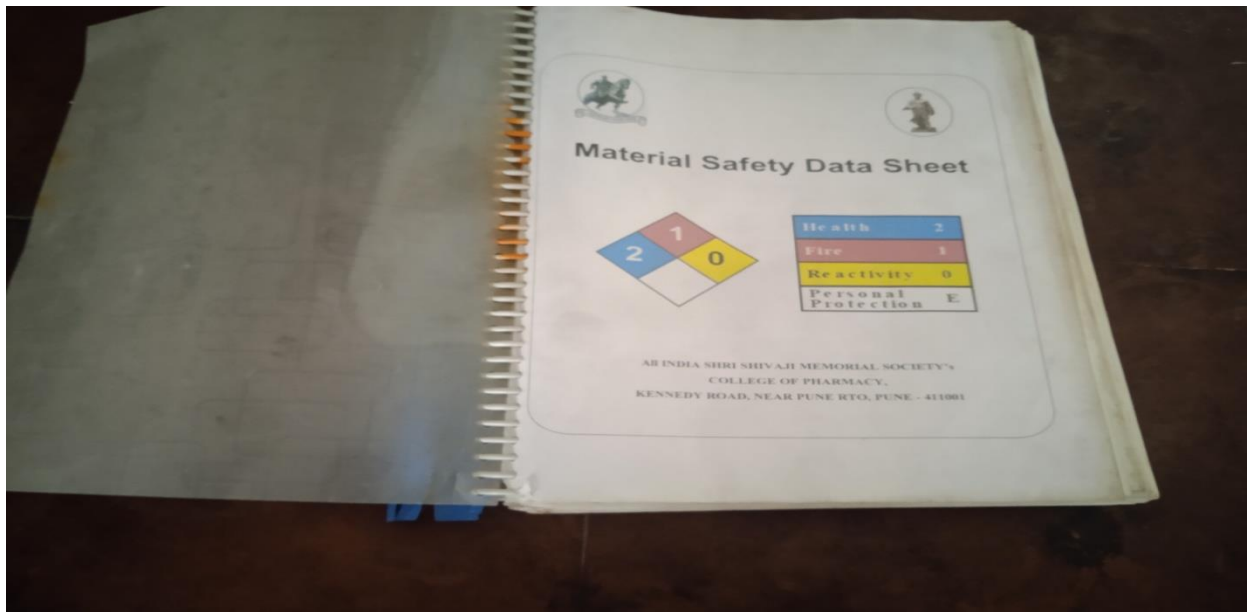

[BACK TO INDEX](#)

## 6. Awareness Boards.

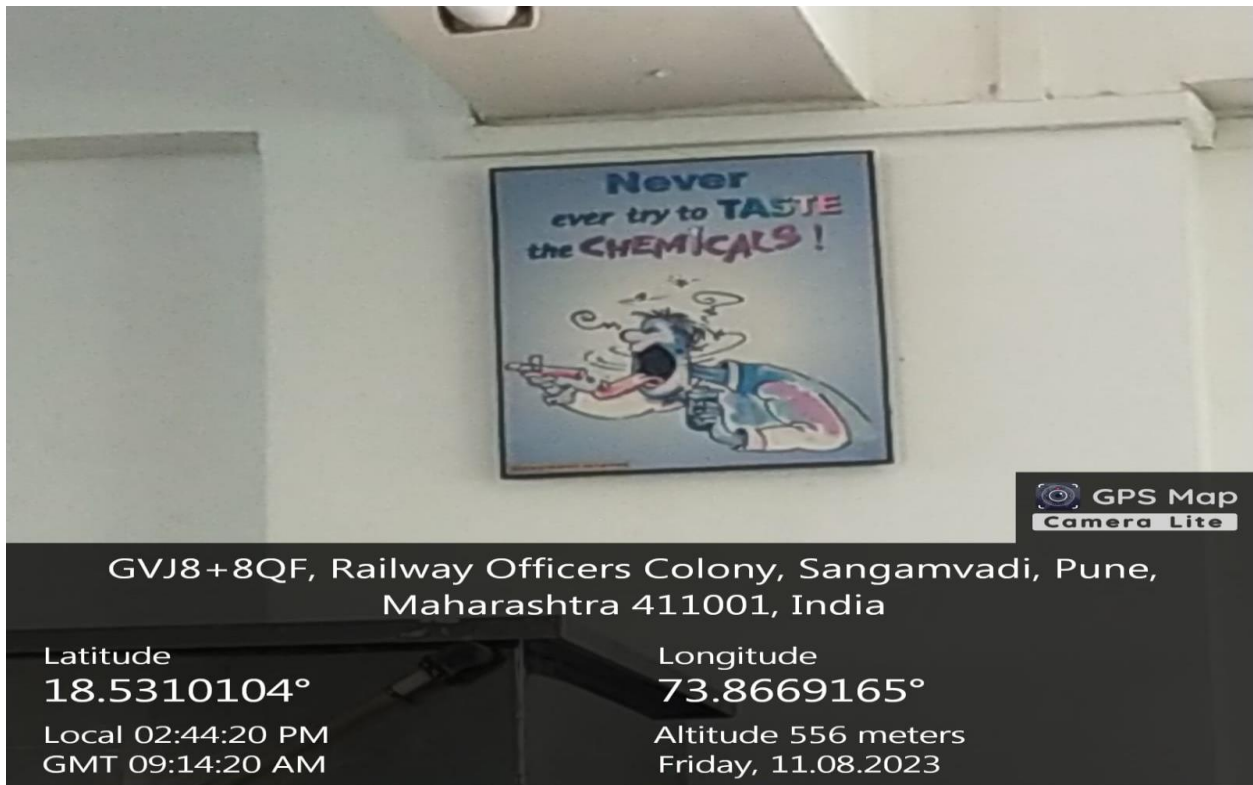
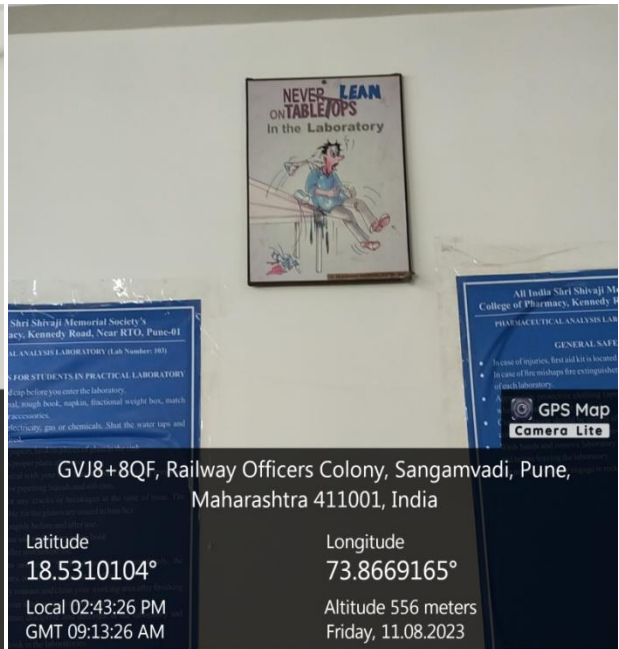
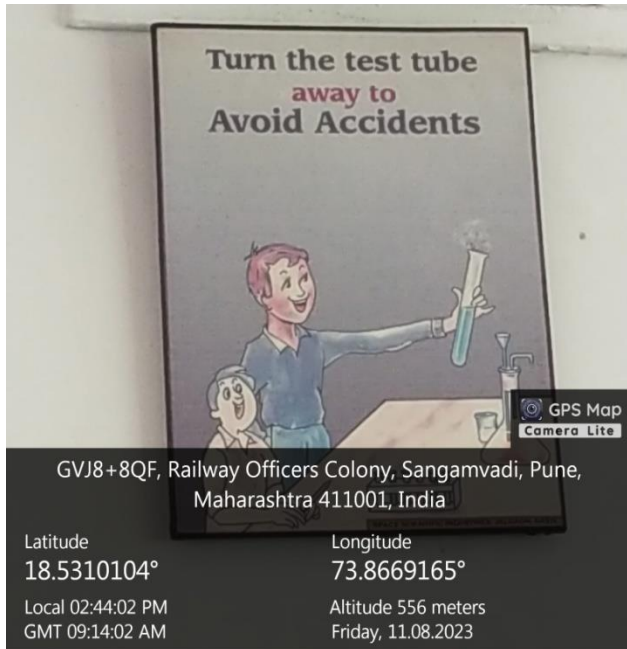

[BACK TO INDEX](#)

### 7.1.2.3: WATER CONSERVATION FACILITIES

#### 1. Rain Water Harvesting

Rain water harvesting is a technique of collection and storage of rainwater into natural reservoirs or tanks, or the infiltration of surface water into subsurface aquifers before it is lost as surface runoff. Rain water harvesting system was incorporated in the architecture plan and has been installed in the college building right from its inception. The water from rooftops and floors is collected through down pipes and discharged in recharge pits of borewell through pipe lines in the campus. The system ensures percolation of the rainwater into soil. Inspection and annual cleaning of the down-pipes is done as a part of general maintenance. Maintenance typically consists of the removal of dirt, leaves and other accumulated materials.

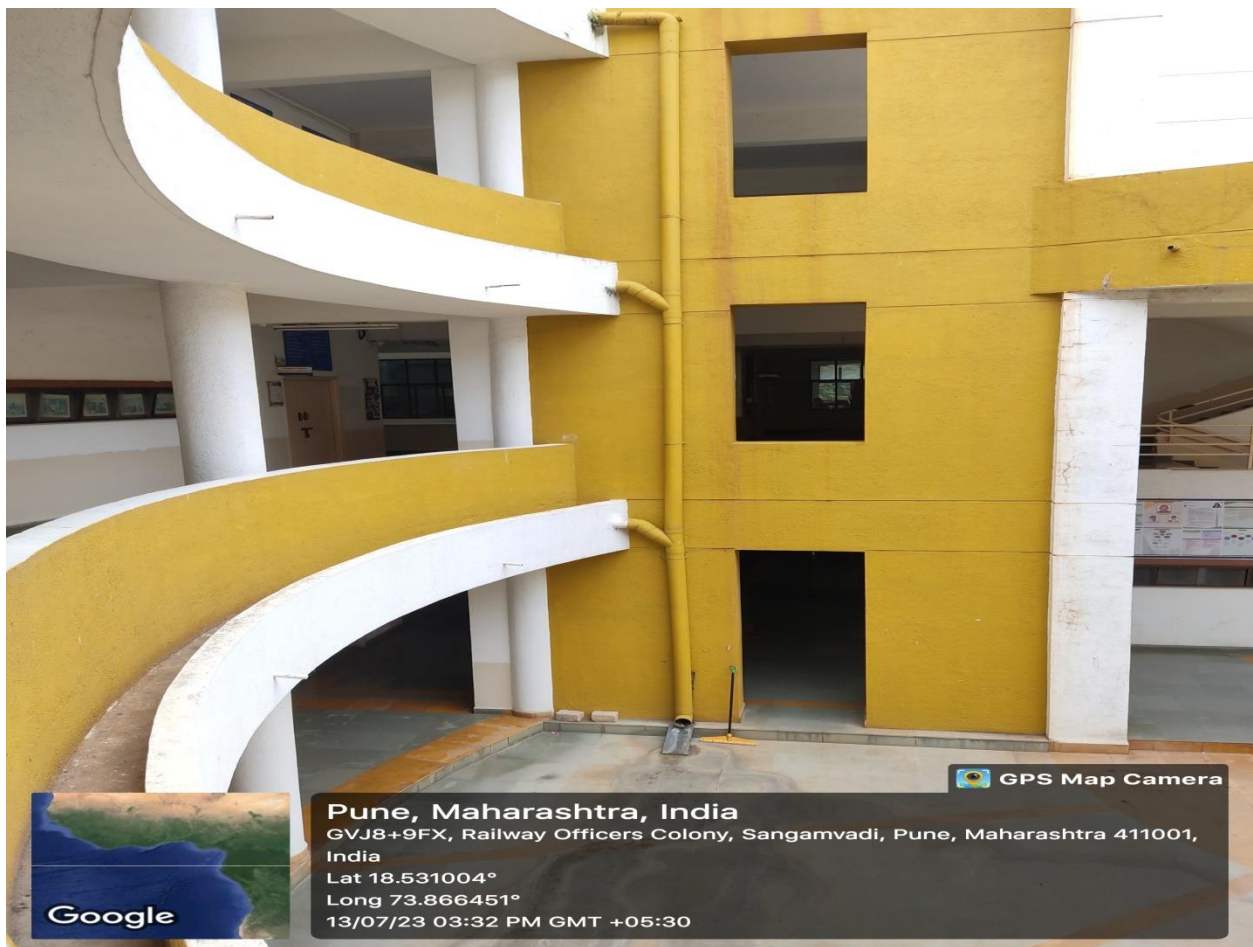

[BACK TO INDEX](#)

## 2. Pits for Rain Water Discharge



[BACK TO INDEX](#)

### 3. Bore Well/Open Well Recharge



[BACK TO INDEX](#)

#### 4. Sprinklers System to save water wastage



[BACK TO INDEX](#)



## 5. Drip Irrigation System to save water wastage

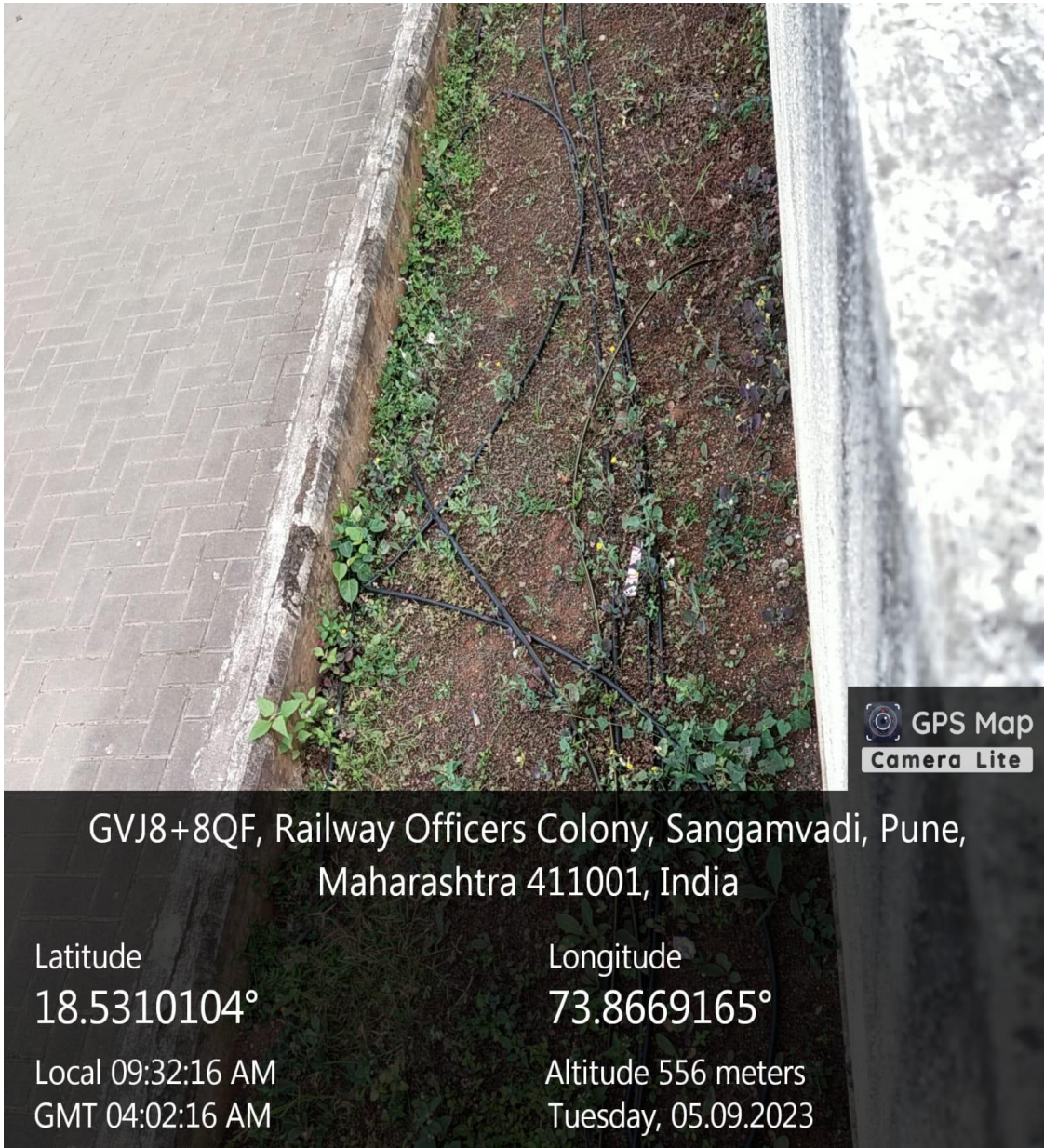

[BACK TO INDEX](#)



 GPS Map  
Camera Lite

GVJ8+8QF, Railway Officers Colony, Sangamvadi, Pune,  
Maharashtra 411001, India

Latitude  
18.5310104°

Longitude  
73.8669165°

Local 09:32:07 AM  
GMT 04:02:07 AM

Altitude 556 meters  
Tuesday, 05.09.2023

[BACK TO INDEX](#)

## 6. Maintenance of Water Bodies and Distribution System in the Campus

### AISSMS CAMPUS LAYOUT

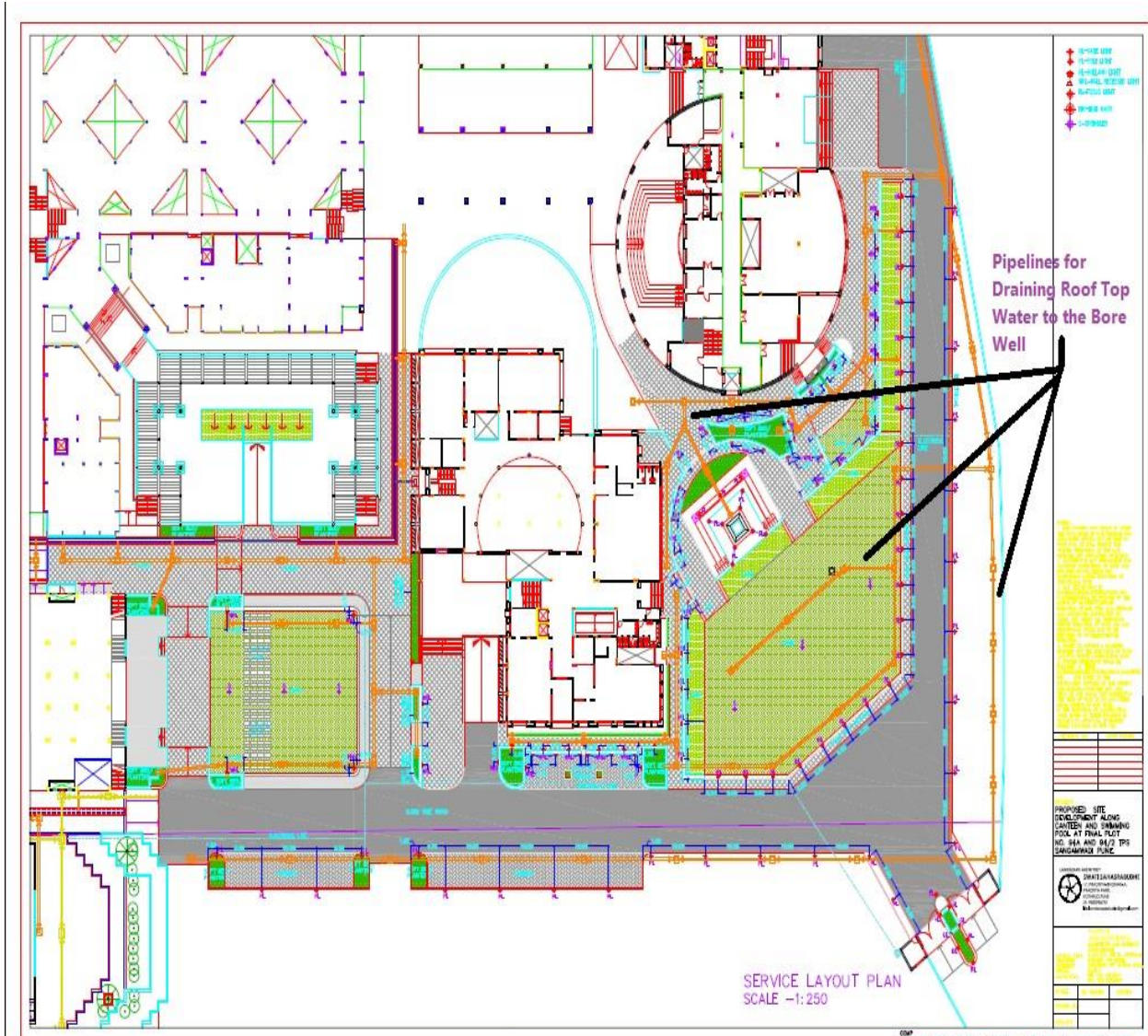

Rain water harvesting system was incorporated in the architecture plan and has been installed in the college building right from its inception. The water from rooftops and floors is collected through down pipes and discharged in the ground as well as in recharge pits near borewell through pipe lines in the campus.

[BACK TO INDEX](#)

## 7. Awareness Signboards

The students and staff are also sensitized towards optimum use of water through sign boards and various activities.



[BACK TO INDEX](#)

## 7.1.2.4: FACILITIES FOR PROMOTING GREEN CAMPUS INITIATIVES

### 1. Green & Clean Campus



[BACK TO INDEX](#)



[BACK TO INDEX](#)

## 2. Wet Waste De-Compost Plant in Medicinal Garden.



[BACK TO INDEX](#)

### 3. Metro Station near Campus.



[BACK TO INDEX](#)





 GPS Map Camera



Pune, Maharashtra, India  
SSPMS School, Sangamvadi, Pune, Maharashtra 411001, India  
Lat 18.530143°  
Long 73.865117°  
14/09/23 11:16 AM GMT +05:30

[BACK TO INDEX](#)

#### 4. Promoting use of Electric Vehicle



**Pune, MH, India**

Sangamwadi, Pune, 411006, MH, India

Lat 18.530903, Long 73.866729

07/25/2023 11:34 AM GMT+05:30

Note : Captured by GPS Map Camera

[BACK TO INDEX](#)

## 5. Promoting use of Bicycle (Bicycle Stand)



[BACK TO INDEX](#)

## 7.1.2.5 DIFFERENTLY ABLED (DIVYANGJAN) FRIENDLINESS FACILITIES

### 1. Built in environment with ramps/lifts for easy access to classrooms

#### A. Physical facilities (Spacious Corridors for easy movement and access to classrooms and laboratories)



[BACK TO INDEX](#)

**B. Provision for lift (Easy movement and access to classrooms and laboratories)**



[BACK TO INDEX](#)

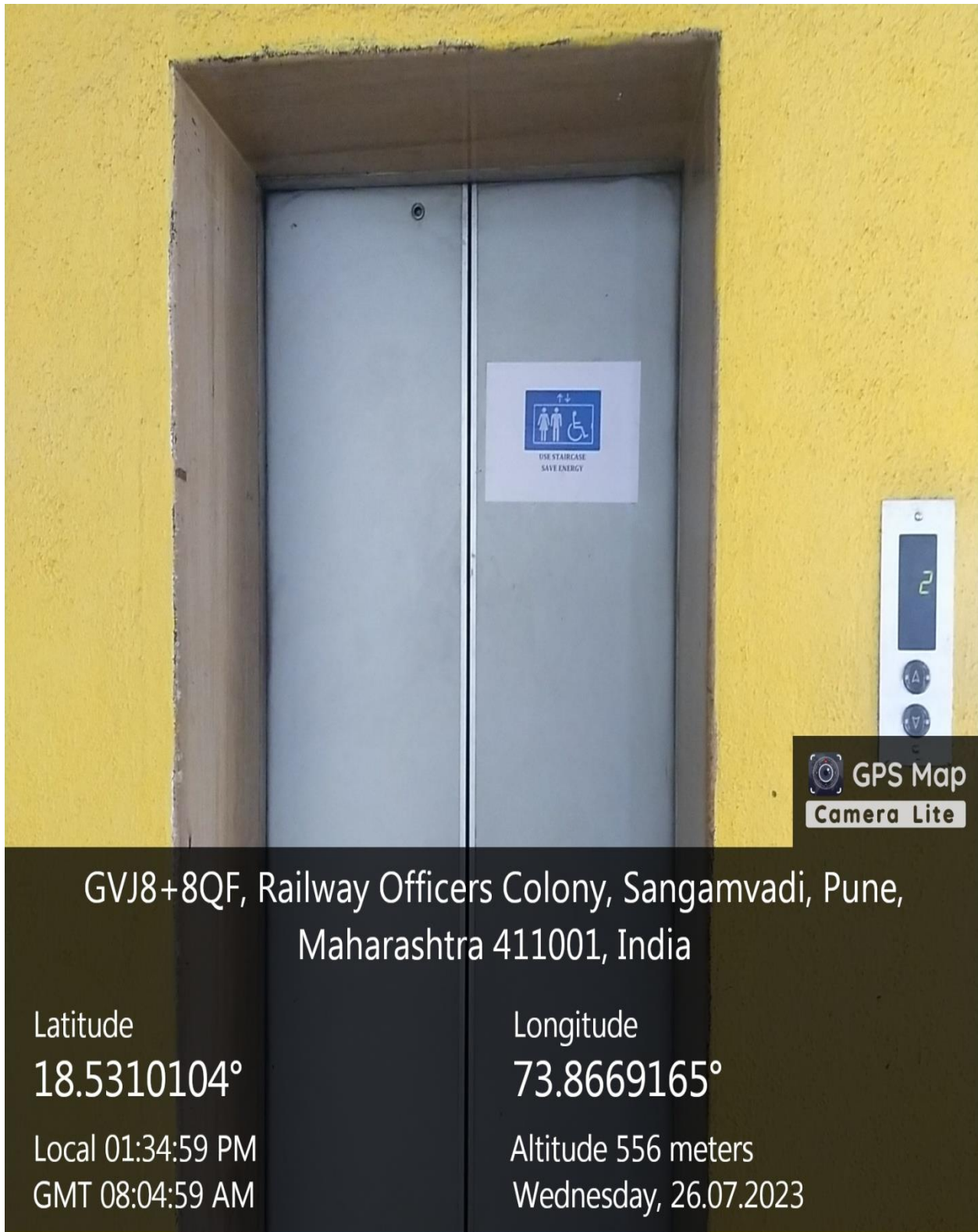

[BACK TO INDEX](#)

**C. Ramp / Rails (To Parking Area as well as Upstairs - Easy movement and access to classrooms and laboratories)**



[BACK TO INDEX](#)



[BACK TO INDEX](#)



## 2. Diyangjan accessible washrooms



[BACK TO INDEX](#)

### 3. Signage including tactile path, lights, display boards and signposts

#### a) Sign/Display boards



[BACK TO INDEX](#)

## b) Tactile Paths



[BACK TO INDEX](#)



GVJ8+9Q3, Railway Officers Colony, Sangamvadi,  
Pune, Maharashtra 411001, India

Latitude

18.5308771°

Local 03:49:02 PM

GMT 10:19:02 AM

Longitude

73.86661618°

Altitude 479.73 meters

Wednesday, 22-09-2021

[BACK TO INDEX](#)

#### 4. Assistive Technology and facilities for persons with disabilities (Divyangjan) –

##### a) Wheel Chair for Divyangjan



610, 6th Floor, IOIT Building, AISSMS College Near  
RTO Office, Sangamwadi, Pune-01, Railway Officers  
Colony, Sangamvadi, Pune, Maharashtra 411001,  
India

Latitude  
18.5312564°

Local 03:43:04 PM  
GMT 10:13:04 AM

Longitude  
73.8663226°

Altitude 482.9 meters  
Wednesday, 22-09-2021

[BACK TO INDEX](#)



**GVJ8+9Q3, Railway Officers Colony, Sangamvadi,  
Pune, Maharashtra 411001, India**

Latitude  
**18.53106896°**

Local 03:41:43 PM  
GMT 10:11:43 AM

Longitude  
**73.8666211°**

Altitude 505.9 meters  
Wednesday, 22-09-2021

[BACK TO INDEX](#)

## b) Braille Software/facilities – (Freeware from Braille-S)

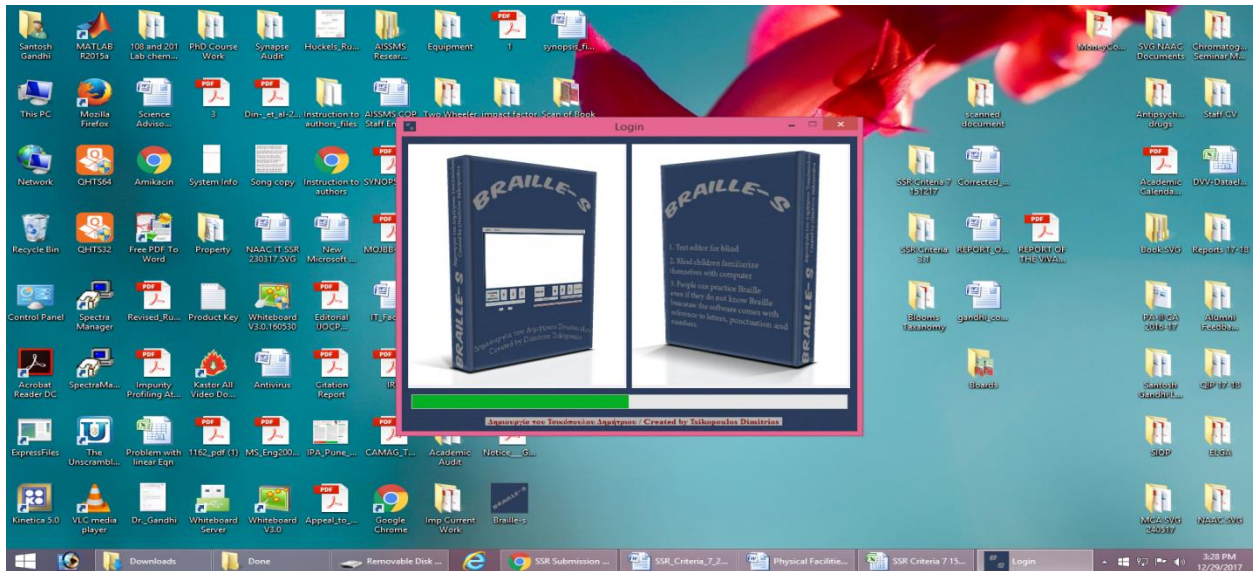

**\*\* No student/faculty with visual impairment admitted in academic years**

**2018-19 to 2022-23**

[BACK TO INDEX](#)

**5. Provision for enquiry and information: Human assistance, reader, scribe, soft copies of reading material, screen reading - Scribes/Extra Time for examination (As per Savitribai Phule Pune Univesrity Rules)**

As per policy document provision is available for Human assistance, reader, scribe, soft copies of reading material, screen reading on request. Scribe facility and extra time was provided to applicants as per Savitribai Phule Pune Univesrity Rules and Norms

Date: \_\_\_\_\_ YOLVA

Amit Shankar Pore  
Final Yr. B Pharm.

To,  
Exam Section  
AISSMS COP.

Subject - Extra time for University Exams (Sem-VIII)

Respected Mam,

Myself Amit. S Pore request you to provide me with extra time for University exams Semester VIII which are commencing from 06<sup>th</sup> June 2023 to 01 July 23.

I request you to please do needful.

Thanking you.

Yours faithfully  
Amit Pore.

OK will be conducted according to SPO rules  
(Prof. Dr. Peshkar)  
Exam Section

[BACK TO INDEX](#)



To, Principle,  
AISSMS College  
of pharmacy,  
Pune.

Subject:- Extra time for physically  
handicapped student.

Respected mam,

I am Saurabh Kantilal  
Jadhav from T. Y. B. Pharm  
Seat No - 33476 Writing this  
Application for the Extra time for  
SPPU physically handicapped student  
for the SPPU examination which is  
held during the 20<sup>th</sup> June to  
7<sup>th</sup> July 2022

Thank you.

your faithfully

Saurabh Jadhav

~~Saurabh~~

T. Y. B. Pharm

Seat No:- 33476

OK  
Principle  
(Dr. Keshava Patil)  
(Exam Section)

[BACK TO INDEX](#)

Date - 16/6/22

To,  
A Principle,  
AISSMS COLLEGE OF PHARMACY,  
PUNE -

SUBJECT - Application for Extra time

Respected Ma'am,

I am Amit Shankar Pore from Third Year B.Pharm Roll no (seat no) - 33582 writing application for giving extra time for physical handicapped student, during SPPU examinations held from 20<sup>th</sup> June to 7<sup>th</sup> July 2022.

Thank You,  
Your Sincerely,  
Amit Pore.



Mob ÷ 7057936057

OK  
Principle  
Exam Section

[BACK TO INDEX](#)